

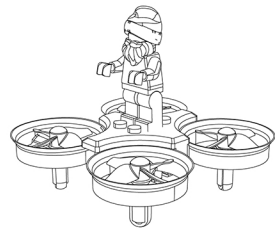

AGE 14+

## KNOW YOUR FLYING SANTA CLAUS

Santa Claus Drone applies building blocks into the drone construction and uses 2.4GHz to enable multiple players compete without any risk of interference. It is easy to operate via remote control to control functions such as flying, 3D flips and rolls, return to home, headless mode and other features.



## FLYING SANTA CLAUS DRONE X BRICK 2 IN 1

\*Please read this manual carefully before operation and keep it properly for future reference.

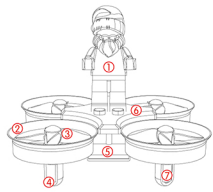

1

## ACCESSORIES

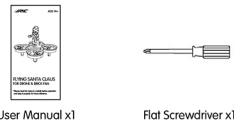
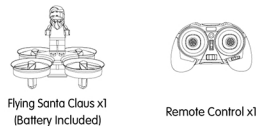

2

## PRE-FLIGHT PREPARATION

### 1. Flight Environment



Indoor: Spacious spaces away from barriers, crowds or pets are preferred.



Outdoor: Sunny, windless and breezy weathers are preferred.



Please keep the drone in sight during the flight and keep it away from barriers, high-tension cables, trees and people.



Do not fly in extreme environment, such as hotness, coldness, strong wind or heavy rain.

3

### 2. Propellers Installation

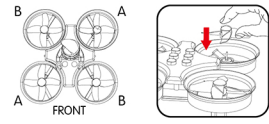

A corresponds to A  
B corresponds to B

### 3. Block-man Installation

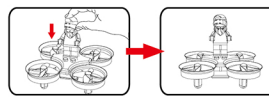

1 Fix Block-man onto the drone.  
2 Block-man stands still above the drone.

### Notes:

When installing or dismantling the propeller, please do not exert force on the propeller to avoid distortion.

4

### 4. Battery Charging for Drone

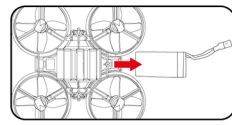

A. Remove the battery from drone bottom.

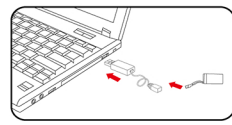

B. Connect USB charging cable with lithium battery and the USB charging interface to charge up.

### Notes:

LED lights on when charging, LED lights off when finish charging. Charging time is about 30-50 minutes.

5

## ▲ Battery Instructions

- There is a certain risk when using lithium battery. It may cause fire, body injury or property loss. Users must be aware of the risks and take full responsibility of using battery improperly.
- If battery leakage occurs, please avoid contacting your eyes or skin with electrolyte. Once it happens, please wash your eyes with clean water and seek medical care immediately.
- Please remove the plug immediately if you sense any peculiar smell, noise or smog.

### Battery Charging

- Please use the charger from original factory to ensure your safe usage.
- Do not charge dilutant or outworn battery.
- Do not over charge battery. Please unplug the charger once fully charged.
- Do not charge the battery next to inflammables, such as carpet, timber floor or wood furniture or on the surface of electro-conductive objects. Please always keep on eye on the battery when charging.
- Do not charge battery which not cool down yet.
- The charging temperature should be between 0°C to 40°C.

### Battery Recycling

- Do not dispose the battery as daily rubbish. Please familiarize yourself with the local garbage disposal method and dispose it according to the special requirement.

6

## KNOW YOUR REMOTE CONTROL

### Operation Board of Remote Control

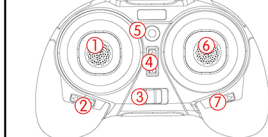

- ① Throttle Joystick/  
Press for Return to Home/Push the Rubber Joystick to Enter Headless Mode During Return
- ② High/Low Speed Control
- ③ Power Switch
- ④ Forward/Backward Fine-Tuning
- ⑤ Indicator Light
- ⑥ Rubber Joystick/Short Press for Flips&Rolls/ Long Press for Three Seconds to Enter Flight Mode (Brick Block Mode/ Power Save Mode)
- ⑦ Left/Right Turn Fine-tuning

### Notes:

Brick Block Mode is set as the default mode during flights. However, it consumes a large amount of power to flip and roll, resulting in shorter flight time. Therefore, it is suggestive to disassemble the block-man and press the mode button for three seconds to switch to another mode for longer flight time.

7

### 1. Battery Assembling for Remote Control

- ① Open the Remote Control Battery Cover  
Open the battery cover by sliding the cover downward (as shown in figure).

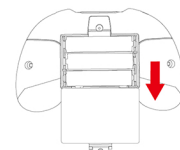

### ② Battery Assembling for Remote Control

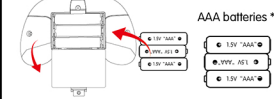

Open the cover of battery compartment, insert three AAA batteries (not included).

8

### 2. Pairing Remote Control with Drone

- ① Turn on the power of the drone; put the drone on plain ground; check whether the indicator lights of remote control and LED lights of drone flash.



- ② Push the accelerator joystick to the top and then pull back to the bottom. On hearing a clear sound, the indicator light of remote control and LED lights of drone will turn from flashing lights to constant lights, which means the pairing completes.

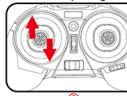

### 3. Calibration

Calibrate the drone when it cannot vertically ascend. Press "Calibration" button and the indicator light of drone would start flashing, then turn to constant light. Thus the calibration completes. Ensure the whole process of calibration is operated under horizontal and steady circumstances.

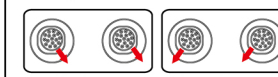

9

## FLY WITH REMOTE CONTROL

### 1. Flying

The left joystick is used to control flying height and left and right turning, while the right joystick is used to control forward, backward and sideward flights.

### Left Joystick

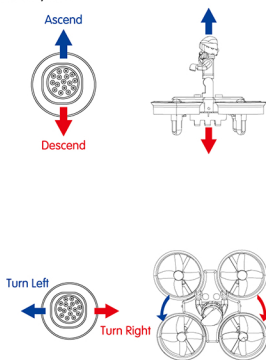

10

### Right Joystick

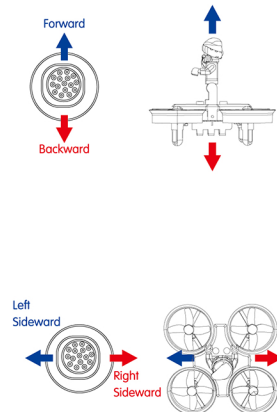

11

### Flips and Rolls

Till the drone flies over 3 meters, press the button of flips and rolls and move the right joystick to certain direction to finalize flips and rolls.  
(Please disassemble the block-man)

### Right Joystick

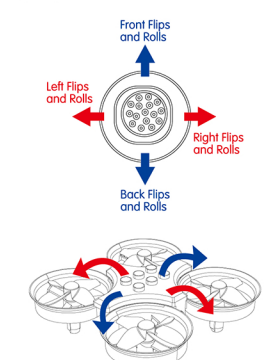

12

### 2. Fine-Tuning

Touch the accelerator joystick to let the drone take off and fly in the air. Calibrate the orientation when the drone yaws or spins.

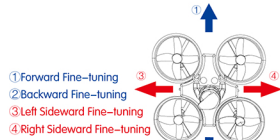
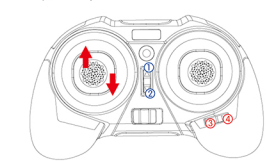

### Notes:

When the drone is within 30cm from the ground, it will be affected by the blade vortex made by itself and become unstable. This is "ground effect". The lighter the drone is, the greater the effect will be.

13

### 3. Headless Mode/Return to Home

Press "Return to Home" and the drone would return automatically along the original route. When the drone flies far away and beyond your vision, press "Return to Home" and push the joystick to enter "Headless Mode", and the drone would return home without worrying about the orientation.

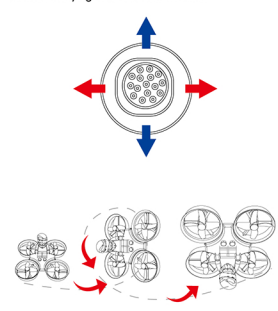

14

## FAQ

PROBLEMS	CAUSES	SOLUTIONS
Control failure	Not connect with the drone battery.	Connect the drone battery in right way.
	Too strong wind force.	Do not fly in windy days. The performance and the control of the drone will be affected by the strong winds.
Fail to ascend	The rotation speed of main blades is too slow.	Push up the throttle joystick.
	The battery of the drone is not fully charged.	Please full charge the drone.
Landing too soon	The throttle joystick is pulled down too fast.	Pull down the throttle joystick slowly to perform a smooth landing.
Out of control	Beyond the effective controlling distance.	Ensure that the flying distance is within 30 meters.

15

## JJRC TECHNICAL SUPPORT

Dear Customer,

Thank you for choosing JJRC product. Please visit JJRC official website for more FAQ and information if there is any problem of using our product.

—Product Operation: Please visit JJRC College for tutorial video or user manual.  
—Product Features: Please refer to product page description or product brochure.  
—After-sale Service: Please refer to conditions and terms of after-sale service.  
The final interpretation right belongs to all JJRC.

Should you have any further questions, please visit JJRC Online Feedback and leave your message.

Thank you again for your support!  
JIANJIAN TECHNOLOGY CO.,LTD.  
www.jjrc-tech.com

16