

Q Series Off-Road RC Car

2.4G R/C 4WD ROCK CRAWLER OFF-ROAD VEHICLE

Know the Interiors

The Remote Control High Speed 4WD Car features 2.4GHz frequency and various functions like forward, backward, left and right steering, braking drift and speeding up. The differential mechanism and shock absorber system help increase the driving stability, bringing a complete fast and furious experience.

Interiors

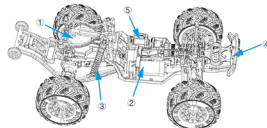

- ① Battery Compartment
- ② Motor
- ③ Rear Shock Springs
- ④ Front Bumper
- ⑤ Circuit Board

Telecontroller

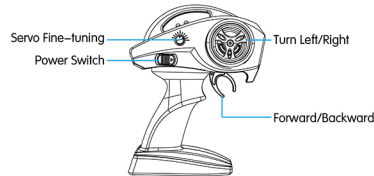

*Please read this manual carefully before operation and keep it properly for future reference.

1

In the box



User Manual x1



Charger x1



Transmitter x1



Flat Screwdriver x1

Notes:

Please check the number of accessories carefully(as shown above). Please provide proof of purchase and contact the store for replacement if any missing parts.

Battery Assembling and Charging

Battery Assembling for Remote Control:

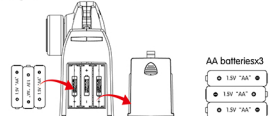

Open the cover of battery compartment, insert two triple-A batteries (optional) and ensure the polarity symbols on the batteries match the symbols inside the battery compartment.

Notes:

- 1.Ensure the polarity symbols on the batteries match the symbols inside the battery compartment.
- 2.Do not mix new and old batteries.
- 3.Do not mix different types of batteries.

2

Body Battery Charging:

- Remove the lithium battery from the battery compartment.
- Insert the charger into the socket and the charger's light will turn green. Ensure the polarity symbols on the batteries match the symbols inside the battery compartment. The charger's light remains red whilst charging and turns to green when the charging cycle completes, which lasts about 150 minutes.
- Afterwards,insert the lithium battery into the battery compartment and connect with the circuit board. Ensure the polarity symbols on the batteries match the inside the battery compartment.
- Adults should be aside to keep an eye on the charging.

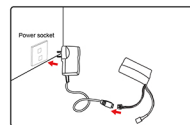
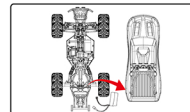

Notes:

- 1.The product is applicable for users aged 8 and the above. For users under the age of 18, a parent or legal guardian shall company and supervise the child's use of this product at all times.
- 2.Great care should be taken when using the electrical appliance. Adhere to safety instructions to avoid electrical shock.
- 3.Please be aware any misbehaved actions would cause problems. Do not disassemble or modify the product.

3

Battery Instructions

- There is a certain risk when using lithium battery. It may cause fire, body injury or property loss. Users must be aware of the risks and take full responsibility of using battery improperly.
- If battery leakage occurs, please avoid contacting your eyes and skin with electrolyte. Once it happens, please wash your eyes with clean water and seek medical care immediately.
- Please remove the plug immediately if you sense any peculiar smell, noise or smog.

Battery Charging

- Please use the charger from original factory to ensure your safe usage.
- Do not charge dilutant or outworn battery.
- Do not over charge battery. Please unplug the charger once fully charged.
- Do not charge the battery next to inflammables, such as carpet, timber floor or wood furniture or on the surface of electro-conductive objects. Please always keep an eye on the battery when charging.
- Do not charge battery which not cool down yet.
- The charging temperature should be between 0°Cto 40°C.

Battery Recycling

- Do not dispose the battery as daily rubbish. Please familiarize yourself with the local garbage disposal method and dispose it according to the special requirement.

4

Operation Instructions

1.Operating Environment

- Do not use in public roads or streets. This might cause accidents.
- Do not use in crowds or animals.
- Do not use in or around ponds or lakes in case the model falls overboard.
- Please comply with the following instructions to reassure the remote control is controllable or safe:To start the car, turn on the car firstly and then the transmitter. To shut down, turn off the transmitter and then the power of the car.
- Do not touch the tires in operation.
- Do not use in the rain or let it pass through the water.
- Do not touch the motor in operation until it cools down.
- Please remove the battery from the car and transmitter after the charging cycle completes.

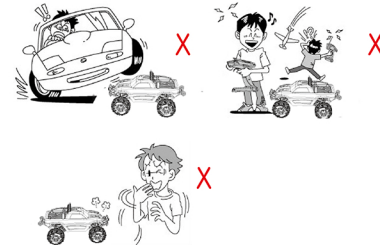

5

2.Operations

- ①Power on the car, then turn on the remote control(see image 1), make sure the power indicator stays on solid, and keep the car stable.If the wheels moved automatically, adjust the fine-tuning button on the remote control till the wheels are motionless. Slide the the trigger on the remote control slowly (see image 2), to observe whether the car is moving forward or backward.
- ②Comply with the instructions and control the turning wheels to left or right (see image 3). Place the car on the ground and stand behind it, and then trigger the valve. If the wheels cannot maintain a straight line, press the fine-tuning button (see image 4) to adjust.

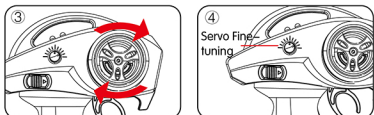
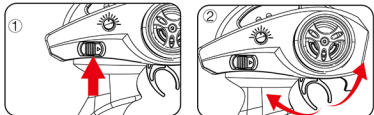

6

3. Practice

- ① Turn the steering wheel to the right to control the car turn right. Turning wheels decides the turning angle.

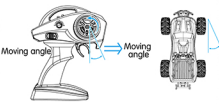

- ② Turn the steering wheel to the left to control the car turn left. Turning wheels decides the turning angle.

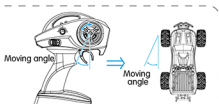

- ③ Pull back the throttle to control the car forward. Adjust the angle of the throttle to control the driving speed.Push the trigger forward quickly to stop the car.

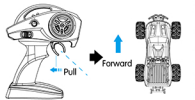

- ④ Release the trigger to the middle to brake.Push the throttle forward to control the car backward.

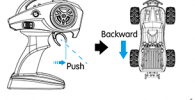

7

Practise! Choose the area like the tower footing resistance (e.g. bottles) to practise. Try to drive fast on the straight lanes, while slowing down on bends.

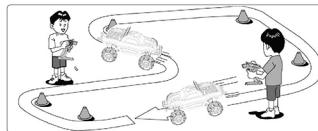

4.Maintenance

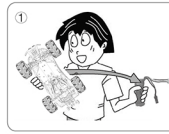

Remove the battery from the car when the car is not in use.

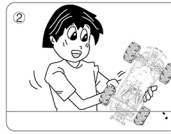

Wipe out sands, muds and dusts.



Apply anti-rust oil onto the metal facade.



Store the car and the battery separately when the car is not in use.

8

FAQs

| Problem | Cause | Solution |
|--------------------------------------------|--------------------------------------------------------------------------|----------------------------------------------------------------------------------------------------|
| | The transmitter and/or receiver might not be switched on. | Turn on the transmitter and/or receiver. |
| Out of control. | Batteries of the transmitter might not be connected. | Connect the batteries of the transmitter. |
| | Power batteries might not be fully charged. | Fully charge the power batteries. |
| Control failure or short control distance. | Batteries of the transmitter and/or receiver might not be fully charged. | Replace with new batteries of the transmitter and fully charge the batteries of the power battery. |

9

JJRC Technical Support

Dear Customer,

Thank you for choosing JJRC product. Please visit JJRC official website for more FAQ and information if there is any problem of using our product.

- Product Operation: Please visit JJRC College for tutorial video or user manual.
- Product Features: Please refer to product page description or product brochure.
- After-sale Service: Please refer to conditions and terms of after-sale service. The final interpretation right belongs to all JJRC.

Should you have any further questions, please visit JJRC Online Feedback and leave your message.

Thank you again for your support!

JIANJIAN TECHNOLOGY CO.,LTD.
www.jjrc-tech.com

10